

We recommend this floor plan  
when our clients don't mind their  
guests sitting so close to each other  
& chargers are not being used

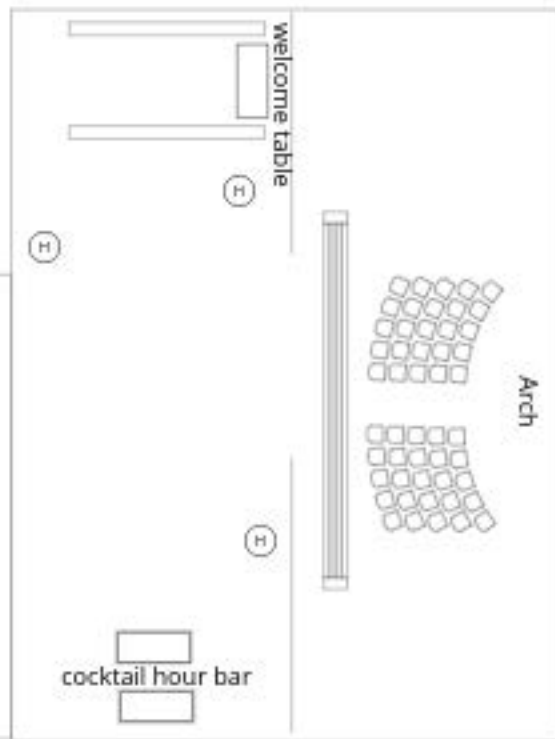

This floor plan is for our clients that don't mind their guests sitting closer to each other & are not using chargers for part of their decor

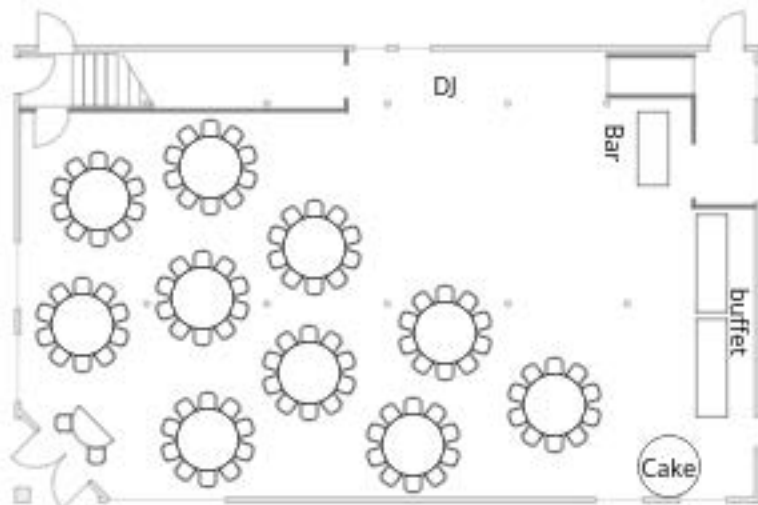
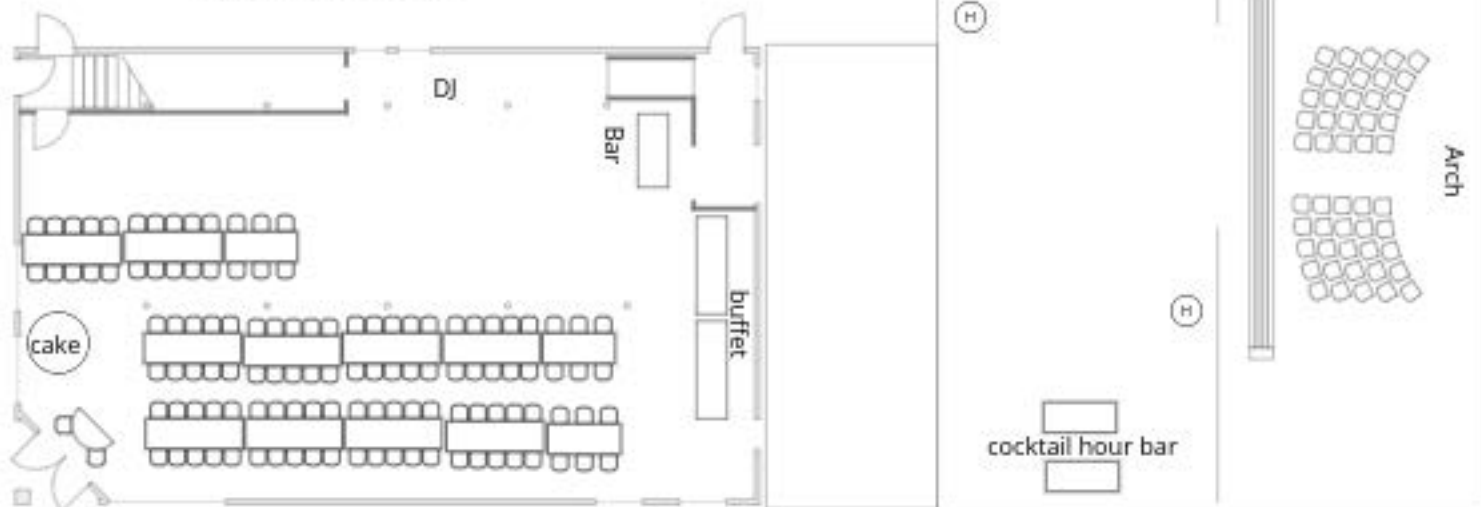

The chairs will be spaced out much further and around our beams that are located in the middle of the room

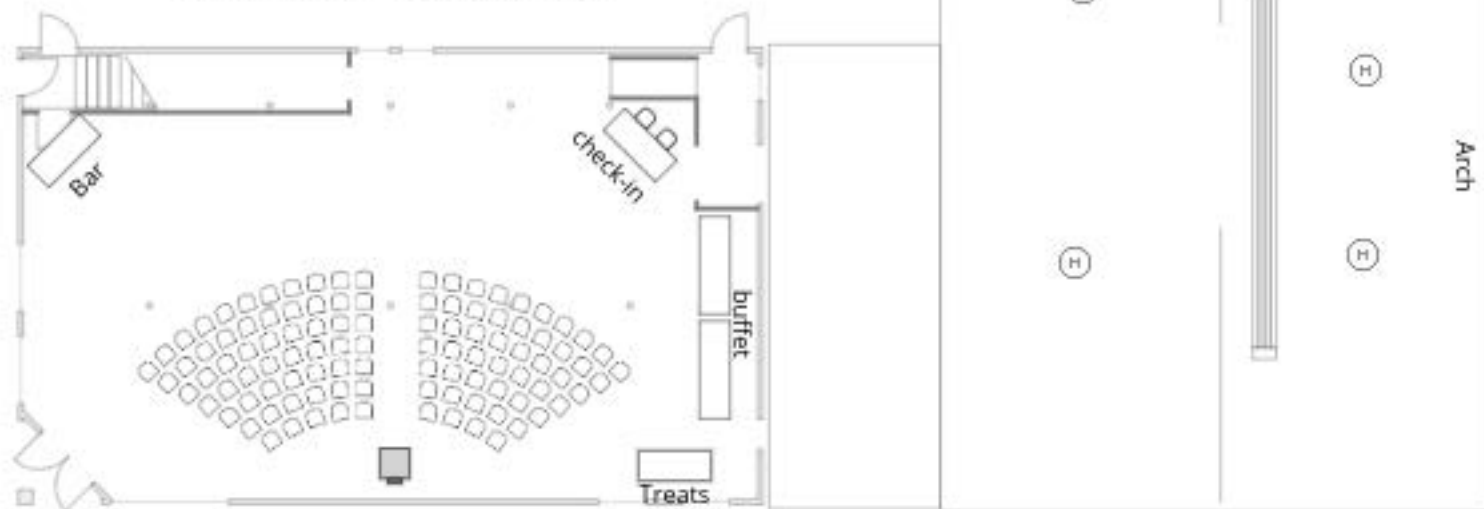

This floor plan is for guest count of 150  
cocktail style arrangement

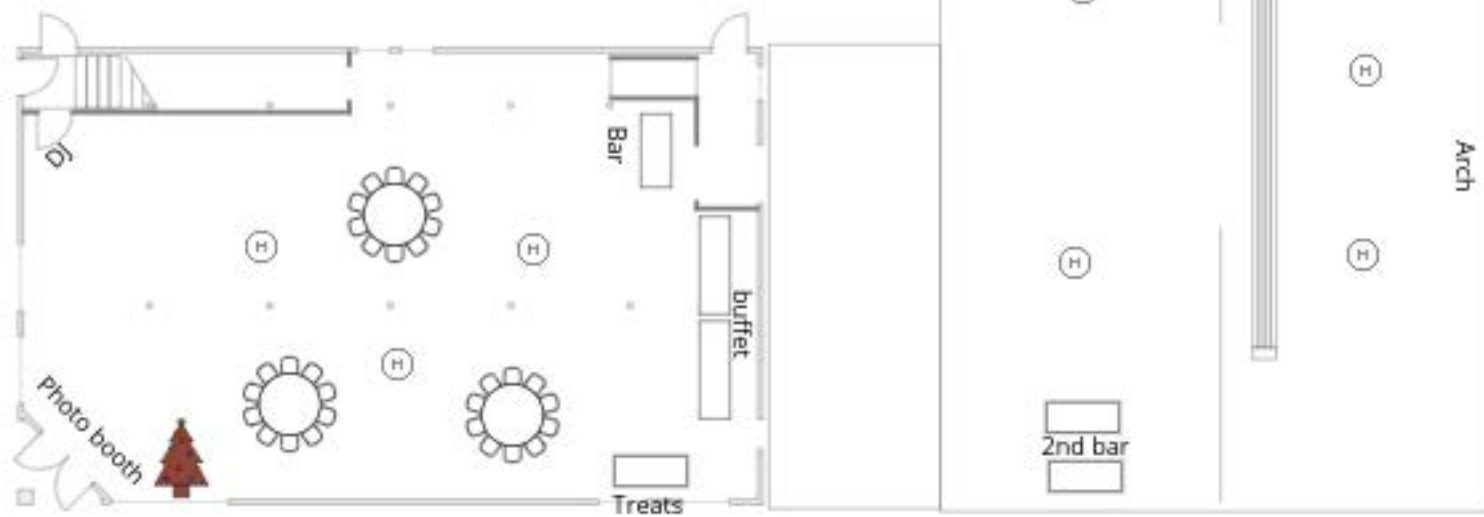

This floor plan is for our clients that don't mind their guests sitting closer to each other & are not using chargers for part of their decor

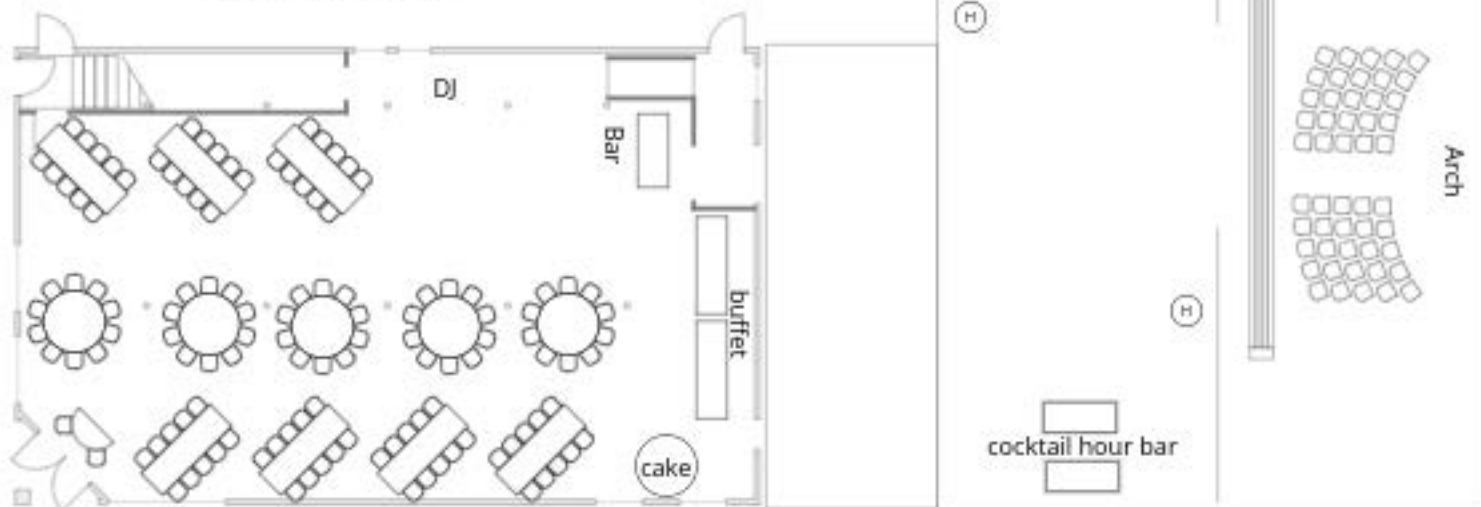



This floor plan is for our clients that don't mind their guests sitting closer to each other & are not using chargers for part of their decor

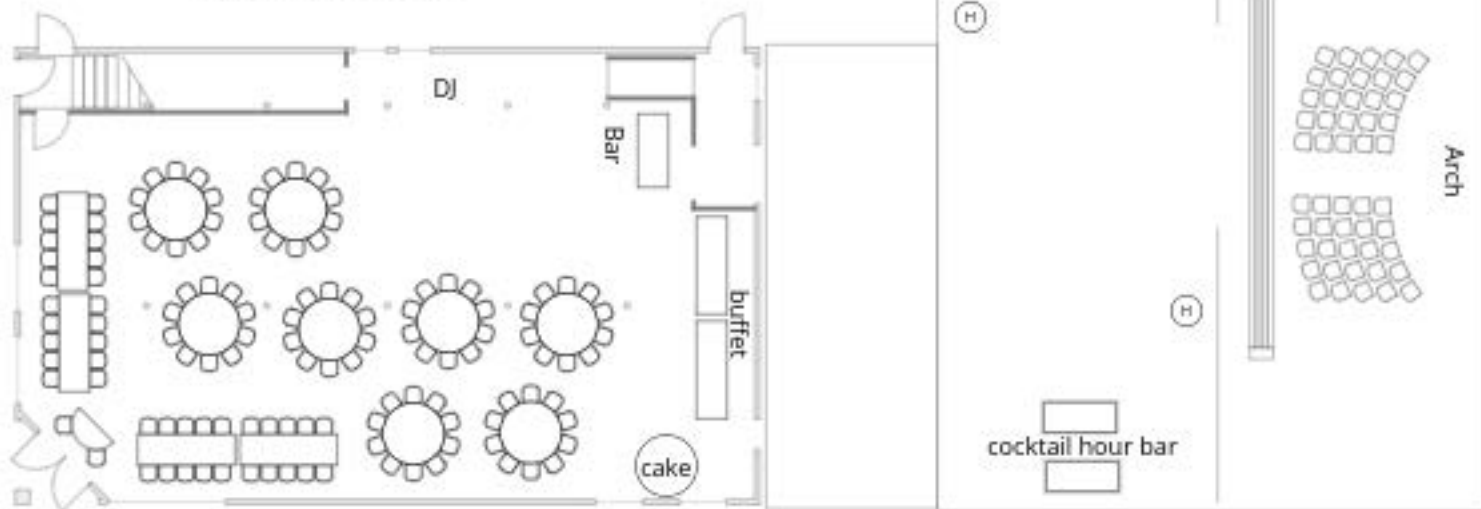

The chairs will be spaced out much further and around our beams that are located in the middle of the room

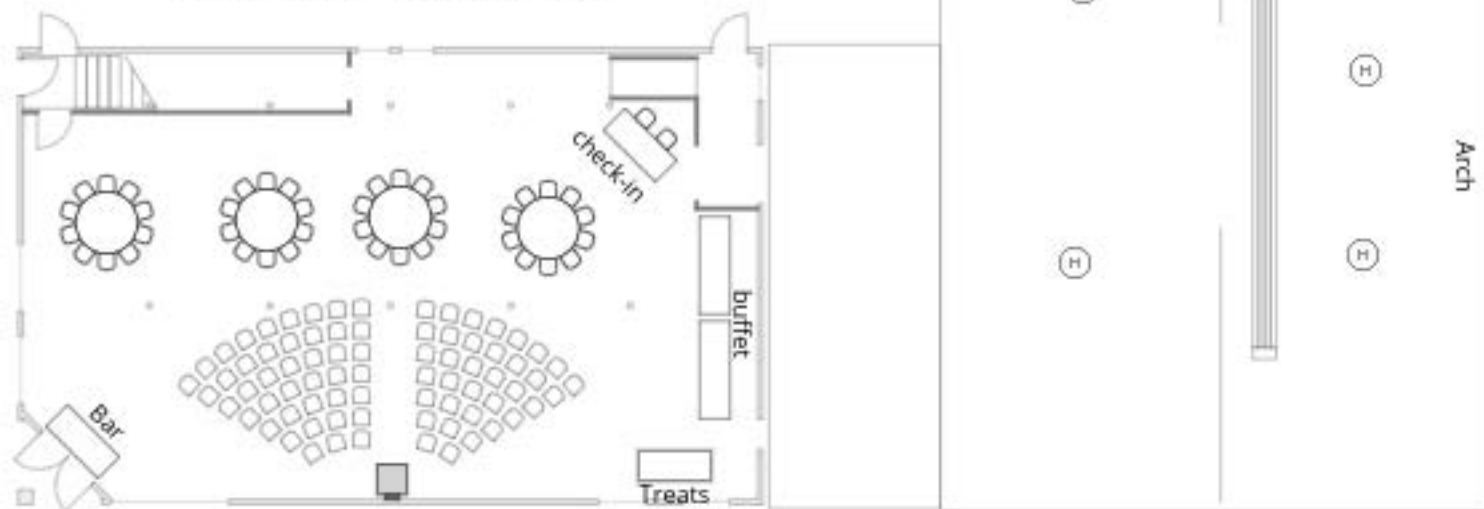

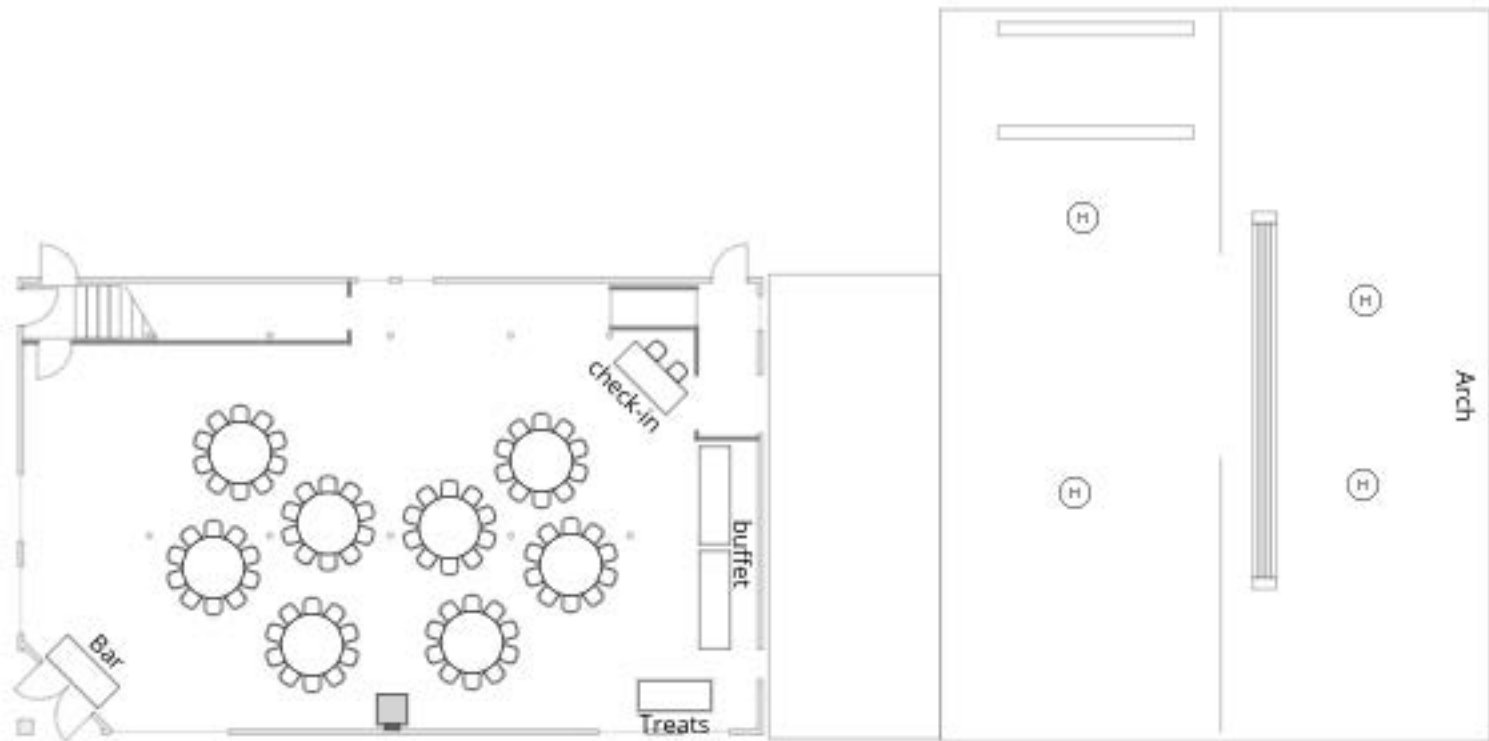

This floor plan is for guest count of 150  
cocktail style arrangement

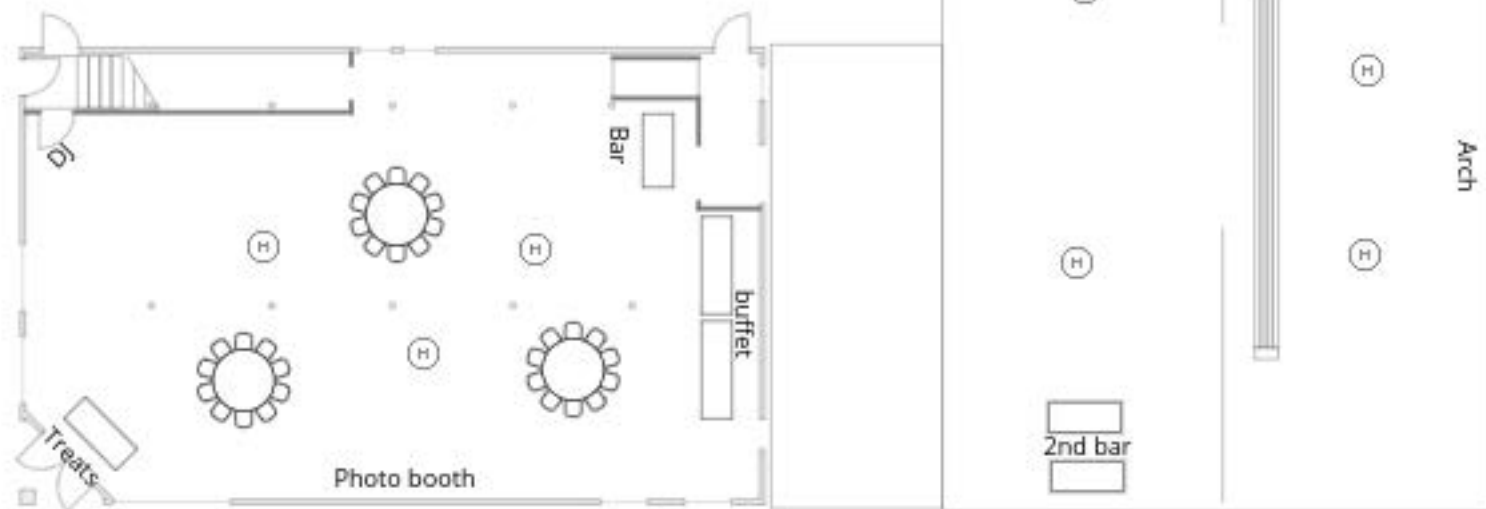

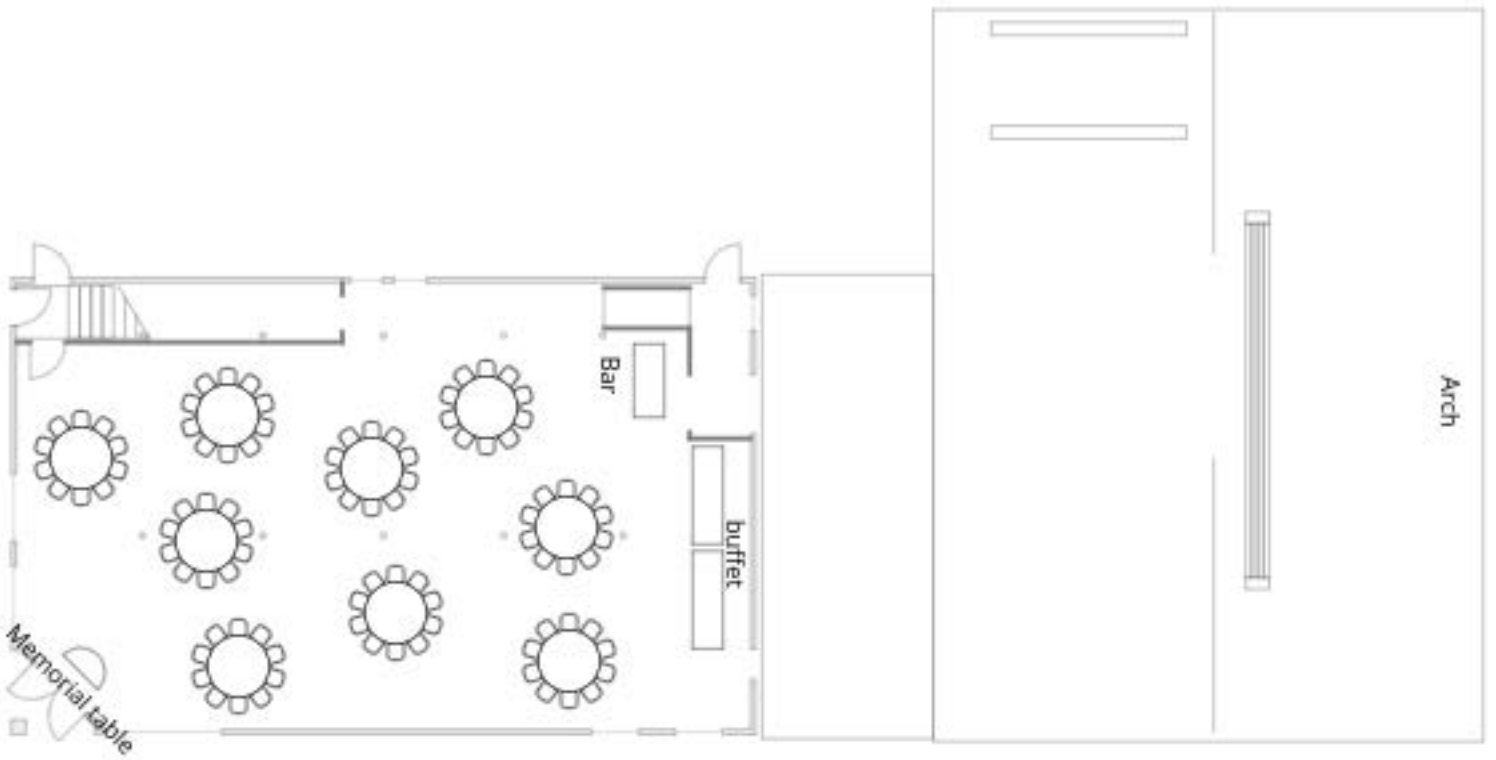

We recommend this floor plan  
when our clients don't mind their  
guests sitting so close to each other  
& chargers are not being used

